

# GARNDE

QUALITY | DESIGN | INNOVATION

## Back-lit LED Panel Light

Standard Flat IP20 Design

UGR<19 Design

IP54 Waterproof Design



HIGH  
OUTPUT LED



85%  
ENERGY  
SAVING



ZERO MERCURY/  
ZERO LEAD



LONG  
LED LIFE

Garnde Lighting Technology Corp.

1377 Jianlan Road, Hi-Tech Zone  
Ningbo 315000, Zhejiang, China

Tel: +86 574 8901 9228

Email: [admin@garnde.com](mailto:admin@garnde.com)

[www.garnde-lighting.com](http://www.garnde-lighting.com)

Garnde lighting is a manufacturer, exporter and lighting solution provider in LED lighting business.

With passion for excellence, Garnde always design and develop products with new technology and possibilities of LED lighting, we care about long lifetime quality and long-term business relationship and always provide products which really create value to client who appreciate quality and details.





## Back-lit LED Panel Light (for GCC)

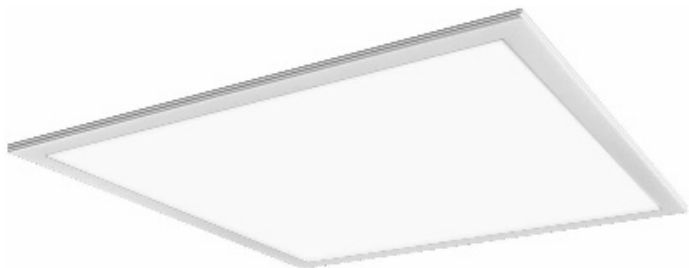

Garnde back-lit standard flat LED panel light is designed to provide a simple LED lighting for high lumen demand spaces. It provides easy installation, long lifespan, no maintenance, no strobe, no buzzing and cold temperature operation. It provides energy savings up to 75% compare to fluorescent tube.



- PET coated steel back housing
- SMD 2835 LED or SMD 4014 LED chips
- PMMA optical lens
- PC diffuser
- Powder coated Aluminum frame

CE CB RoHS IEC  
EN60598

## Application

- Office
- Residence
- Shopping mall
- Parking lot
- Warehouse
- Hotel
- Bus, train, boat
- Airport, railway station, metro station

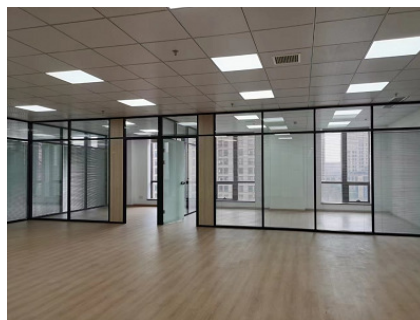

## Spectrogram

3000K:

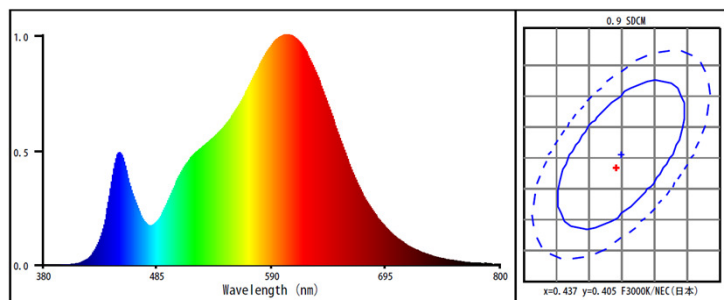

4000K:

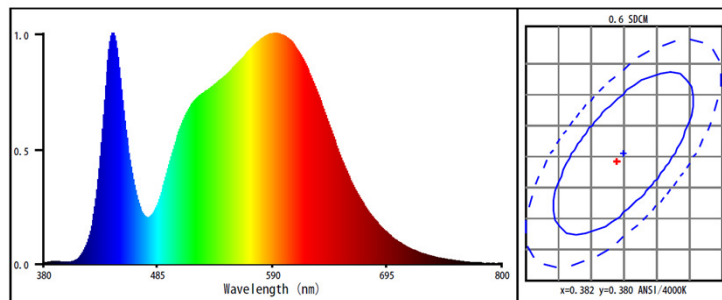

6500K:

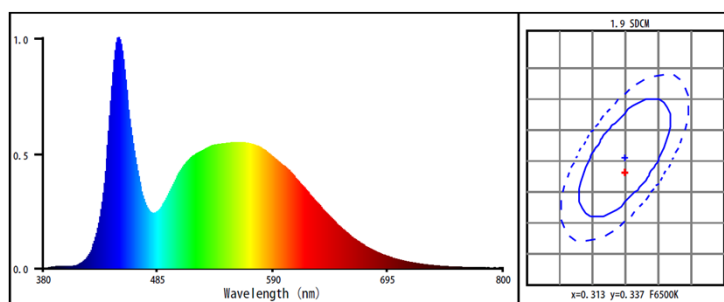

## Light Distribution Diagram

(40W, 6500K):

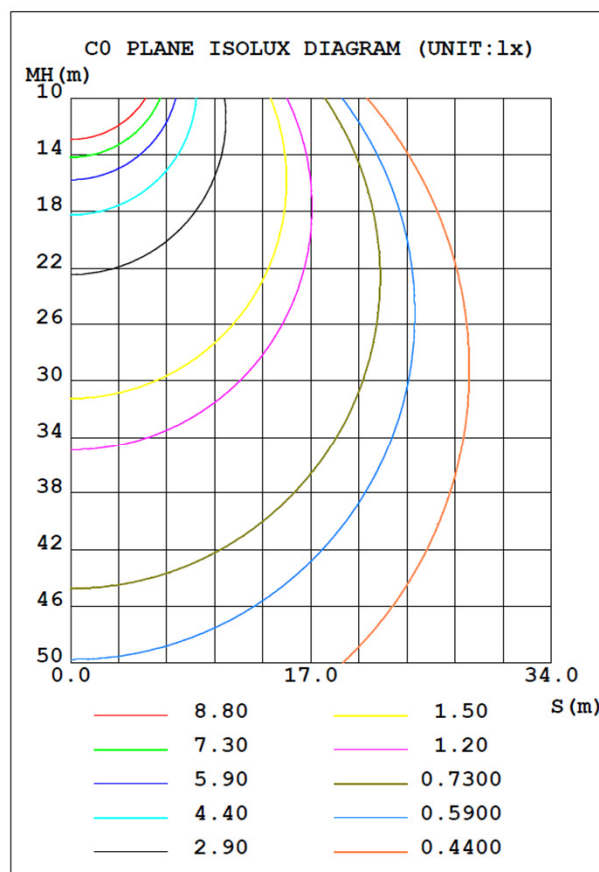
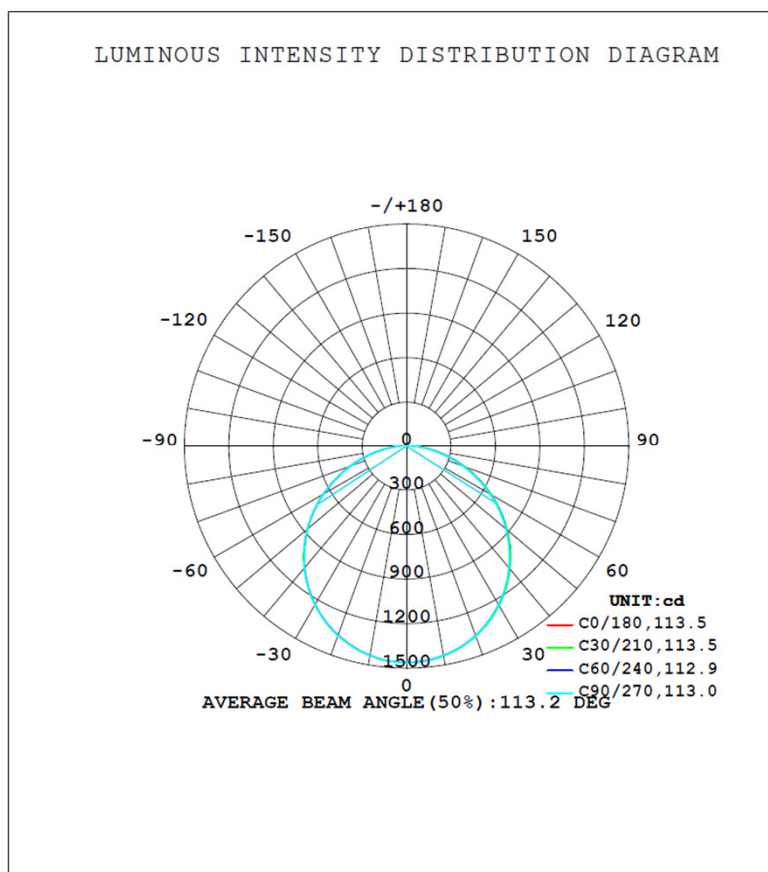

## 595x595 series

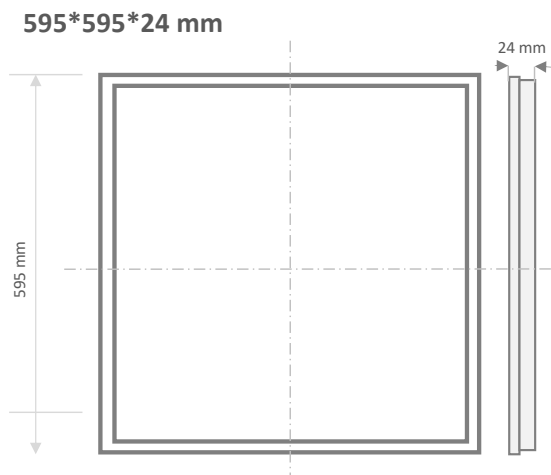

## Technical Characteristics

Size	595 x 595 x 24 mm
Voltage Input Options	220-240V, 100-240V
IP Grade	IP20
Dimmable Options	No, 0-10V, DALI
Wattage	40W
Number of Switch Cycles before Failure	> 15,000

Color Temperature (CCT) Options	3000K, 4000K, 5000K, 6500K
Color Rendering Index (CRI)	Ra > 80
Beam Angle	114°
Power Factor	> 0.9
Strobe	No
Starting Time	< 0.5 s

## Model List

Model No.	Size	CCT	Power (W)	Lumen Output	CRI	Input Voltage	Order Code
PTB-S595-40	595 x 595 x 24 mm	3000K	40W	3750	≥ 80	AC220-240V 50/60Hz	103033
PTB-S595-40		4000K		3940			104033
PTB-S595-40		5000K		4060			105033
PTB-S595-40		6500K		4240			106533

\* Lumen flux and power are subject to an initial tolerance of  $\pm 3\%$ . Tolerance of CCT:  $\pm 3\%$ . Tolerance of CRI:  $\pm 2$ . Values apply to an ambient temperature of 25°C.

## LED Driver Options

Garnde Integrated LED Driver



Philips LED Driver



Torbo LED Driver



600x600 series

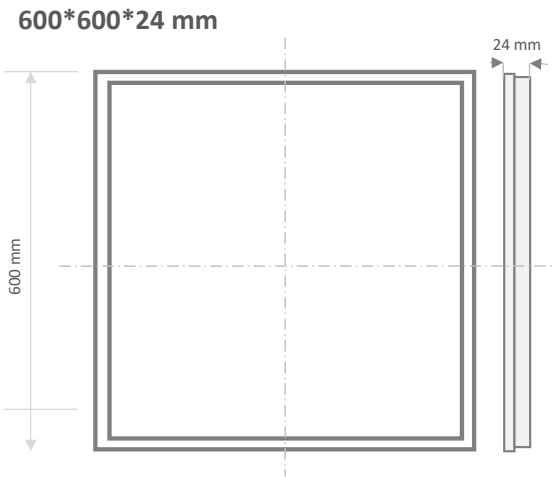

Technical Characteristics

Size	600 x 600 x 24 mm
Voltage Input Options	220-240V, 100-240V
IP Grade	IP20
Dimmable Options	No, 0-10V, DALI
Wattage	40W
Number of Switch Cycles before Failure	> 15,000

Color Temperature (CCT) Options	3000K, 4000K, 5000K, 6500K
Color Rendering Index (CRI)	Ra > 80
Beam Angle	114°
Power Factor	> 0.9
Strobe	No
Starting Time	< 0.5 s

Model List

Model No.	Size	CCT	Power (W)	Lumen Output	CRI	Input Voltage	Order Code
PTB-S600-40	600 x 600 x 24 mm	3000K	40W	3750	≥ 80	AC220-240V 50/60Hz	203033
PTB-S600-40		4000K		3940			204033
PTB-S600-40		5000K		4060			205033
PTB-S600-40		6500K		4240			206533

\* Lumen flux and power are subject to an initial tolerance of ±3%. Tolerance of CCT: ±3%. Tolerance of CRI: ±2. Values apply to an ambient temperature of 25°C.

LED Driver Options

Garnde Integrated LED Driver



Philips LED Driver



Torbo LED Driver



295x1195 series



295\*1195\*24 mm

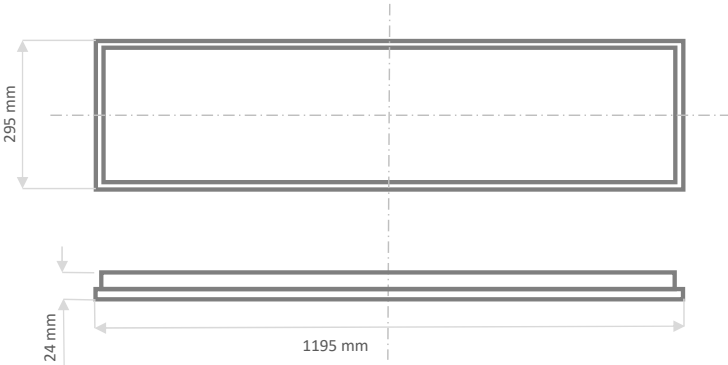

Technical Characteristics

Size	295 x 1195 x 24 mm
Voltage Input Options	220-240V, 100-240V
IP Grade	IP20
Dimmable Options	No, 0-10V, DALI
Wattage	40W
Number of Switch Cycles before Failure	> 15,000

Color Temperature (CCT) Options	3000K, 4000K, 5000K, 6500K
Color Rendering Index (CRI)	Ra > 80
Beam Angle	114°
Power Factor	> 0.9
Strobe	No
Starting Time	< 0.5 s

Model List

Model No.	Size	CCT	Power (W)	Lumen Output	CRI	Input Voltage	Order Code
PTB-2951195-40	295 x 1195 x 24 mm	3000K	40W	3750	≥ 80	AC220-240V 50/60Hz	303033
PTB-2951195-40		4000K		3940			304033
PTB-2951195-40		5000K		4060			305033
PTB-2951195-40		6500K		4240			306533

\* Lumen flux and power are subject to an initial tolerance of ±3%. Tolerance of CCT: ±3%. Tolerance of CRI: ±2. Values apply to an ambient temperature of 25°C.

LED Driver Options

Garnde Integrated LED Driver



Philips LED Driver



Torbo LED Driver





300x1200 series

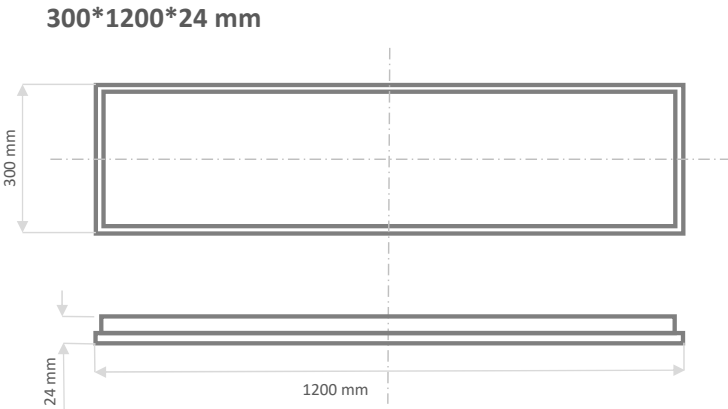

Technical Characteristics

Size	300 x 1200 x 24 mm
Voltage Input Options	220-240V, 100-240V
IP Grade	IP20
Dimmable Options	No, 0-10V, DALI
Wattage	40W
Number of Switch Cycles before Failure	> 15,000

Color Temperature (CCT) Options	3000K, 4000K, 5000K, 6500K
Color Rendering Index (CRI)	Ra > 80
Beam Angle	114°
Power Factor	> 0.9
Strobe	No
Starting Time	< 0.5 s

Model List

Model No.	Size	CCT	Power (W)	Lumen Output	CRI	Input Voltage	Order Code
PTB-3001200-40	300 x 1200 x 24 mm	3000K	40W	3750	≥ 80	AC220-240V 50/60Hz	403033
PTB-3001200-40		4000K		3940			404033
PTB-3001200-40		5000K		4060			405033
PTB-3001200-40		6500K		4240			406533

\* Lumen flux and power are subject to an initial tolerance of ±3%. Tolerance of CCT: ±3%. Tolerance of CRI: ±2. Values apply to an ambient temperature of 25°C.

LED Driver Options

Garnde Integrated LED Driver



Philips LED Driver



Torbo LED Driver





## 595x1195 series

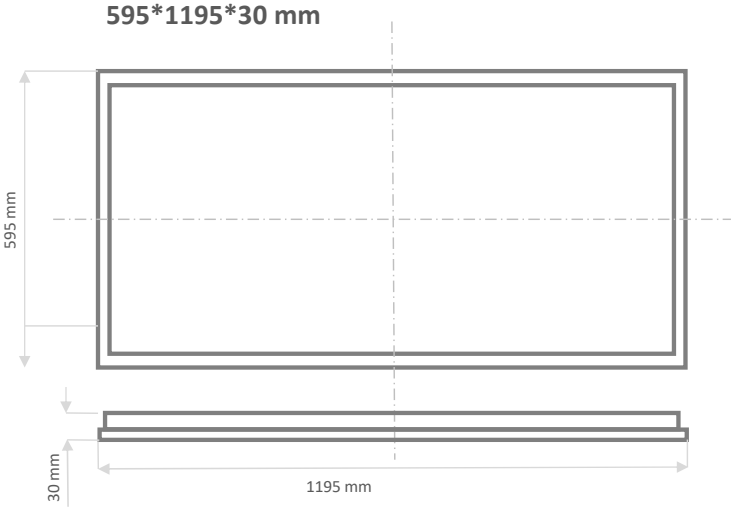

### Technical Characteristics

Size	595 x 1195 x 30 mm
Voltage Input	100-240VAC
IP Grade	IP20
Dimmable Options	No, 0-10V, DALI
Wattage	60W
Number of Switch	
Cycles before Failure	> 15,000

Color Temperature (CCT) Options	3000K, 4000K, 5000K, 6500K
Color Rendering Index (CRI)	Ra > 80
Beam Angle	114°
Power Factor	> 0.9
Strobe	No
Starting Time	< 0.5 s

### Model List

Model No.	Size	CCT	Power (W)	Lumen Output	CRI	Input Voltage	Order Code
PTB-5951195-60	595 x 1195 x 30 mm	3000K	60W	5350	≥ 80	AC100-240V 50/60Hz	503011
PTB-5951195-60		4000K		5940			504011
PTB-5951195-60		5000K		6120			505011
PTB-5951195-60		6500K		6380			506511

\* Lumen flux and power are subject to an initial tolerance of ±3%. Tolerance of CCT: ±3%. Tolerance of CRI: ±2. Values apply to an ambient temperature of 25°C.

### LED Driver

Torbo LED Driver



600x1200 series

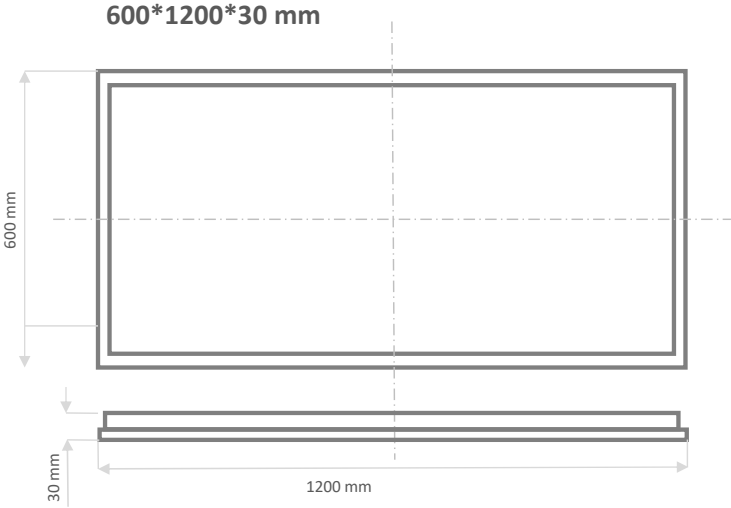

Technical Characteristics

Size	600 x 1200 x 30 mm
Voltage Input	100-240VAC
IP Grade	IP20
Dimmable Options	No, 0-10V, DALI
Wattage	60W
Number of Switch Cycles before Failure	> 15,000

Color Temperature (CCT) Options	3000K, 4000K, 5000K, 6500K
Color Rendering Index (CRI)	Ra > 80
Beam Angle	114°
Power Factor	> 0.9
Strobe	No
Starting Time	< 0.5 s

Model List

Model No.	Size	CCT	Power (W)	Lumen Output	CRI	Input Voltage	Order Code
PTB-6001200-60	600 x 1200 x 30 mm	3000K	60W	5350	≥ 80	AC100-240V 50/60Hz	603011
PTB-6001200-60		4000K		5940			604011
PTB-6001200-60		5000K		6120			605011
PTB-6001200-60		6500K		6380			606511

\* Lumen flux and power are subject to an initial tolerance of ±3%. Tolerance of CCT: ±3%. Tolerance of CRI: ±2. Values apply to an ambient temperature of 25°C.

LED Driver

Torbo LED Driver



## UGR<19

## Back-lit LED Panel Light (for GCC)



Microprism Diffuser

In addition to providing the function of standard LED panel light, Garnde UGR<19 LED Panel Light can also eliminate glare, alleviate people's visual fatigue and improve visual comfort.



- PET coated steel back housing
- SMD 2835 LED or SMD 4014 LED chips
- PMMA optical lens
- PC diffuser
- Microprism Diffuser
- Powder coated Aluminum frame



**RoHS**

**IEC**  
EN60598

595x595 series

600x600 series

295x1195 series

300x1200 series

595x1195 series

600x1200 series

## Technical Characteristics

<b>Voltage Input Options</b>	220-240V, 100-240V
<b>IP Grade</b>	IP20
<b>Dimmable Options</b>	No, 0-10V, DALI
<b>UGR</b>	< 19
<b>Number of Switch Cycles before Failure</b>	> 15,000

<b>Color Temperature (CCT) Options</b>	3000K, 4000K, 5000K, 6500K
<b>Color Rendering Index (CRI)</b>	Ra > 80
<b>Beam Angle</b>	114°
<b>Power Factor</b>	> 0.9
<b>Strobe</b>	No
<b>Starting Time</b>	< 0.5 s

## IP54 Waterproof Back-lit LED Panel Light (for GCC)

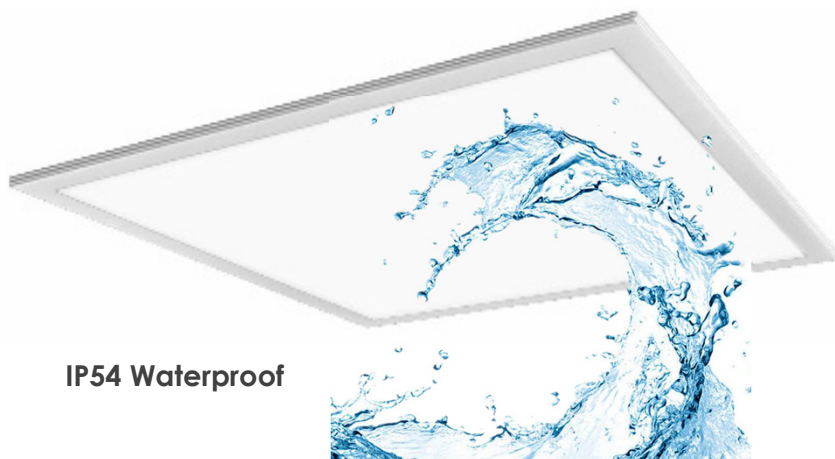

IP54 Waterproof

Garnde IP54 Waterproof LED Panel Light is designed to be used in humid environment or in dusty environment. It can extend the service life time of panel light compare with IP20 LED panel light.



- PET coated steel back housing
- SMD 2835 LED or SMD 4014 LED chips
- PMMA optical lens
- PC diffuser
- (Microprism Diffuser)
- Powder coated Aluminum frame

CE CB RoHS IEC  
EN60598

595x595 series

600x600 series

295x1195 series

300x1200 series

595x1195 series

600x1200 series

### Technical Characteristics

Voltage Input Options	220-240V, 100-240V
IP Grade	IP54
Dimmable Options	No, 0-10V, DALI
Number of Switch	
Cycles before Failure	> 15,000

Color Temperature (CCT) Options	3000K, 4000K, 5000K, 6500K
Color Rendering Index (CRI)	Ra > 80
Beam Angle	114°
Power Factor	> 0.9
Strobe	No
Starting Time	< 0.5 s



## Mounting Method Options

### Recessed

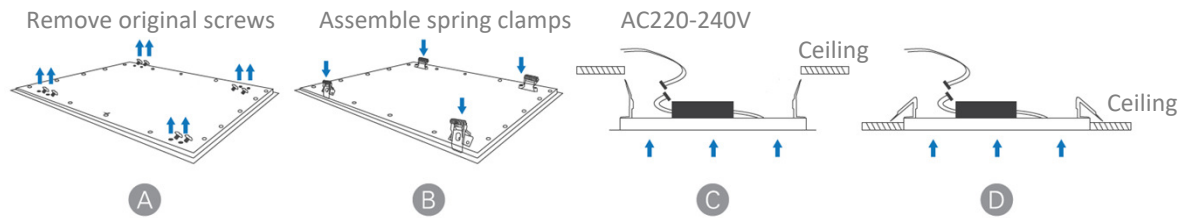

Accessories

### Surfaced

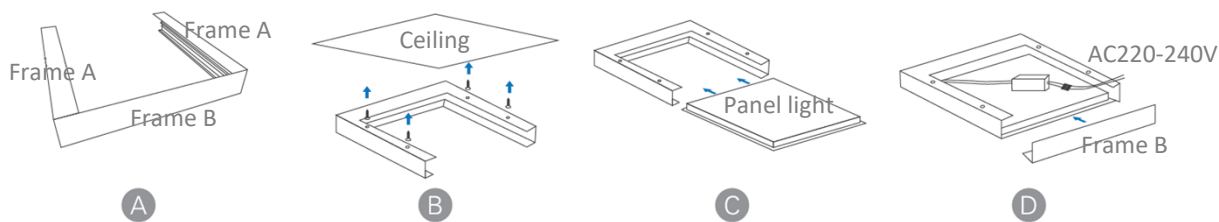

Accessories

### Suspended

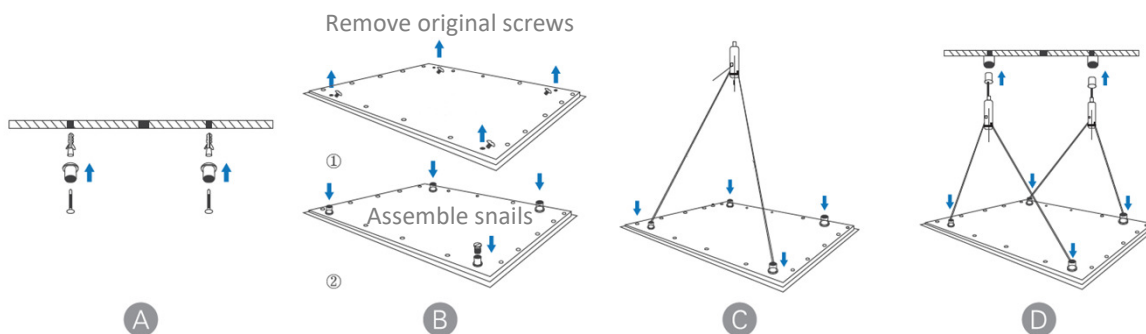

Accessories

## LED Panel Light Emergency Power Supply Solution



LED Emergency Power Supply  
(Emergency LED Driver)

- Only for LED load
- Suitable for a wide range LED load power 0 - 60W
- To power a LED luminaire at a reduced lumen flux
- Automatically activated in the event of power cuts
- Low power consumption
- Over-charge protection and over-discharge protection

### Connection Diagram

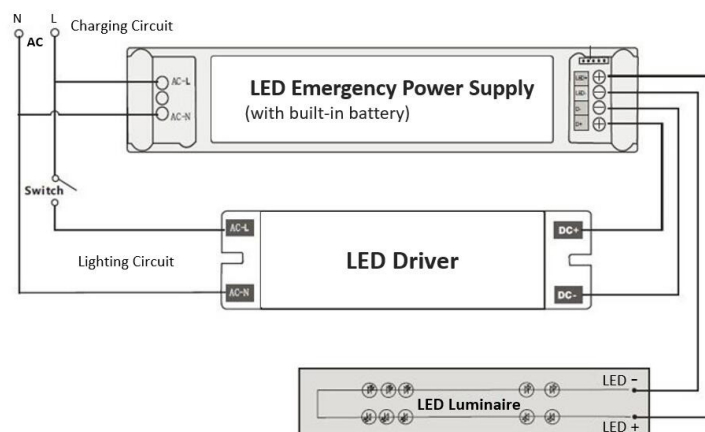

Model No.	EPS2000-0401	EPS2000-0403
LED Luminaire Power Range	Indoor LED light 0 - 60W	
Max. LED Driver Current Connected	2000mA	
Input Voltage	AC100-277V 50-60Hz	
Output Emergency Power	4W	
Output Voltage	DC10V - 80V	
Rated Duration	1.5 hours	3 hours
Built-in Battery	Lithium 7.4V 1.1Ah	Lithium 7.4V 2.2Ah
Charging Time	24 hours	
Protection	Over-charge Protection, Over-discharge Protection	
Indication LED	Red, Green	
Test Facility	Momentary Test Switch	
Operating Temperature	-10℃ ~ + 50℃	
IP Grade	IP40	
Dimensions	215 x 40 x 28 mm	
Standards/Compliance	IEC 61347-2-7, SS 563	

# Mains AC Input Lighting State

Version 01/ TV.E.20

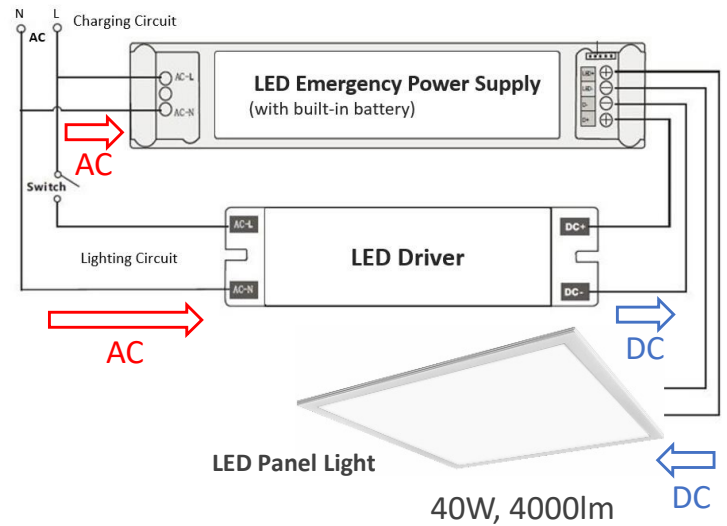

- Mains AC input, LED driver drives LED panel light or similar LED lighting fixture for normal lighting: 40W, 4000lm / panel.
- At same time, mains AC charges the Built-in Battery of *LED Emergency Power Supply*.

## Power Cut Off



# Emergency Lighting State

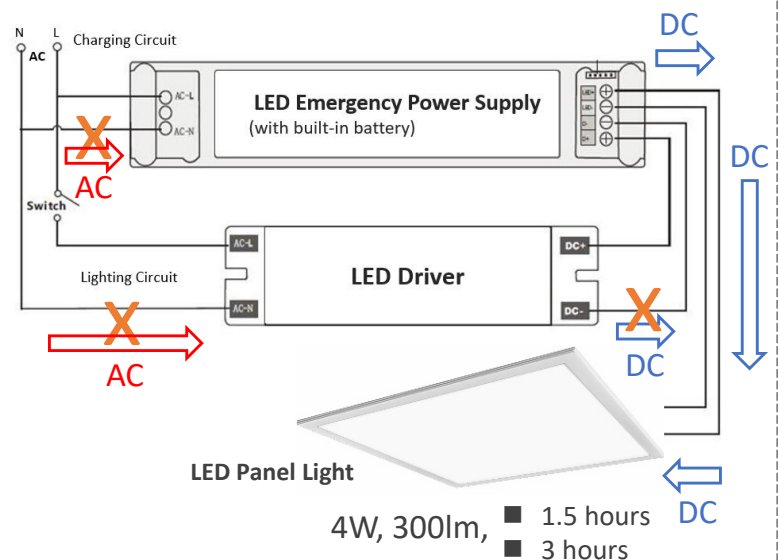
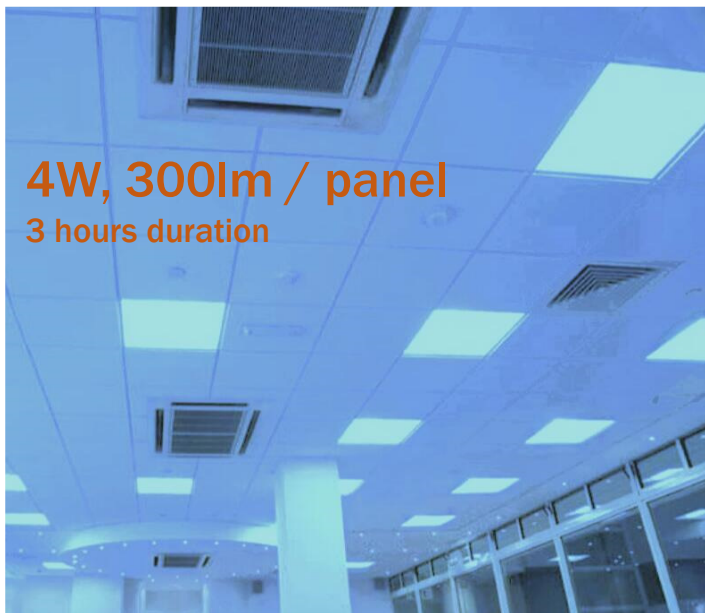

- When the power is cut off, LED driver will no longer work.
- The *LED Emergency Power Supply* will start to work immediately to supply power to LED panel light.
- LED panel light in emergency lighting state: 4W, 300lm / panel, 3 hours duration.

# **GARNDE**

**Garnde Lighting Technology Corp.**

1377 Jianlan Road, Hi-Tech Zone

Ningbo 315000, Zhejiang, China

Tel: +86 574 8901 9228

Email: [admin@garnde.com](mailto:admin@garnde.com)

[www.garnde-lighting.com](http://www.garnde-lighting.com)